

PROFILE DESIGNER

**i**physio<sup>®</sup>

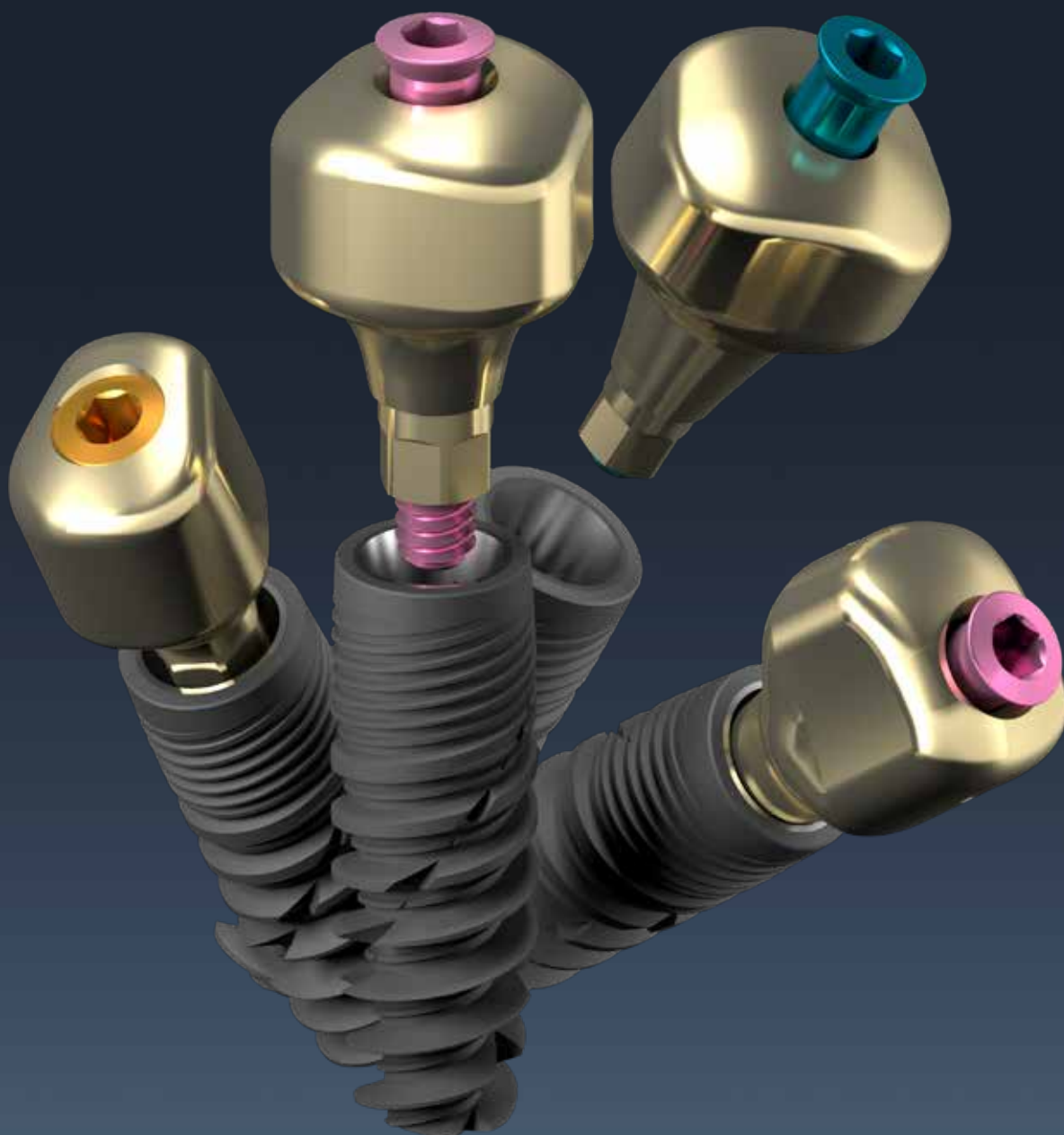

**RANGE AND REFERENCES**

## STARTER KITS - Valid only once

- ▶ The discovery box puts at your disposal all the products necessary to realize your first clinical cases:
  - A set of 6 or 9 iphysio® Profile Designers sterile for single use (one of each shape A, B, C and one of each height)
  - 1 iphysio® try in Profile Designers kit with iphysio® try in reusable (one of each shape and one of each height)
  - 3 iPhysio® temporary prosthesis



Compatibility	Reference
Anthogyr® - Axiom® BL REG et PX	<b>CDIAAX</b>
Biotech Dental® - Kontakt®, Kontakt S®	<b>CDIBKO</b>
GlobalD® - In-Kone® Universal et Primo	<b>CDIGIK</b>
Nobel Biocare® - NobelActive®, NobelReplace® CC et NobelParallel® CC Implant Direct® - InterActive®	<b>CDINCC</b>
Straumann® - Bone Level (BL) et Bone Level Tapered (BLT)	<b>CDISBL</b>
Zimmer Biomet® - Tapered Screw-Vent®, Trabecular Metal / MIS® - SEVEN® et M4® Implant Direct® - Legacy® / BioHorizons® - Internal, Tapered Internal, Tapered Plus	<b>CDIZSC</b>
Alpha-Bio Tec® - NeO, SPI, I.C.E., DFI, ATID / A.B. Dental® - I2, I22, I5, I55, I10	<b>CDIZSC35</b>
etk® Naturactis, Naturall+, Natea+, Astra Tech® - OsseoSpeed™ TX Ocean/Aqua Easy Implant® - Master-C, Master-S Ocean	<b>CDIE3N</b>

## PREMIUM KIT

Ref : CDIE3NP - 359 € TTC

### ▶ Content:

2 implants etk Naturactis Ø 3.5 and Ø 4, 1 drill Ø 2.2, 1 point drill, 1 short cylindrical drill stop etk Naturactis Ø 2.8, Ø 3.3 and Ø 3.8, 1 direct implant key, 1 external hexagonal key, 1 external hexagonal mandrel, 1 iphysio® Profile Designer Shape B Height 2, 1 iphysio® Profile Designer Shape C Height 2

## IPHYSIO PROFILE DESIGNERS

### ▶ Profile Designers

For single use  
Supplied with a coloured attachment screw compatible with the external hexagonal keys of 1.2 mm

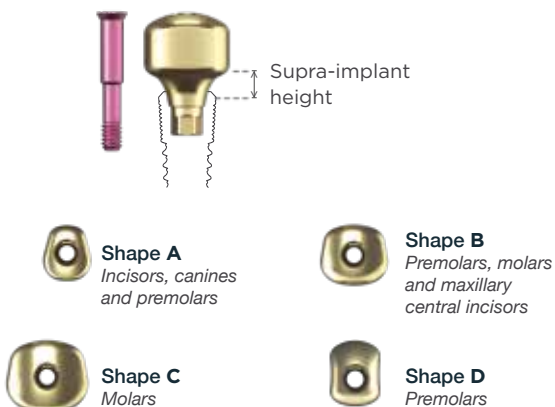

See references in the table p 4-5

## TEMPORARY PROSTHESIS

### ▶ Temporary abutments

Clippable  
Supplied with a black attachment screw compatible with the external hexagonal keys of 1.2 mm

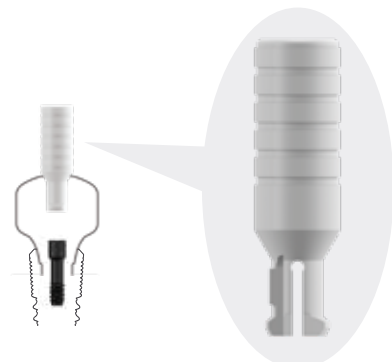

See references in the table p 4-5

## TRY IN PROFILE DESIGNERS

### ► iPhysio® try in Profile Designers kit

To help you select the most suitable Profile Designer for your clinical case  
Sterilisable kit

For implants  
Astra tech®,  
Easy Implant®,  
etk®  
(See detail  
p4 & p5)

Ref

KIE\_3N



For other  
implant brands  
(See detail  
p4 & p5)

Ref

KIE\_U



### ► Try in Profile Designers

Sold per unit  
Can be sterilised and reused

	Shape			
	A	B	C	D
● h 1 mm	NCI_IE.A1	NCI_IE.B1	NCI_IE.C1	NCI_IE.D1
● h 2 mm	NCI_IE.A2	NCI_IE.B2	NCI_IE.C2	NCI_IE.D2
	-	NCI_IE.B2S	NCI_IE.C2S	-
	10° 20°	NCI_IE.A2.10 NCI_IE.A2.20		
● h 3 mm	-	NCI_IE.B3S	NCI_IE.C3S	-
● h 4 mm	NCI_IE.A4	NCI_IE.B4	NCI_IE.C4	NCI_IE.D4



### ► Try in Profile Designers

Sold per unit  
Can be sterilised and reused

	Shape		
	A	B	C
● h 1 mm	IE_U.A1	IE_U.B1	IE_U.C1
● h 3 mm	IE_U.A3	IE_U.B3	IE_U.C3

## EXTRACTORS

### ► Abutment extractors

Recommended for removal of the Profile Designers on Anthogyr Axiom®, Biotech Kontakt® and GlobalD In-Kone® implants owing to the closed conicity of these connections.



	Reference
<b>Anthogyr® Axiom®</b>	CEP_16.175
<b>Biotech Dental® Kontakt®</b>	CEP_14.175
<b>Global D® In-Kone®</b>	CEP_18.175

## KEYS

► A key for all your prosthetic parts. External hexagonal keys of 1.2 mm, in manual version or contra-angle, for screwing all prosthetic parts in the range iPhysio.

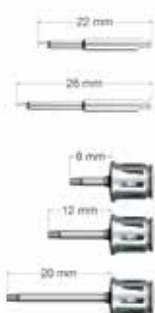

Version	Manual key	For contra-angle
<b>Short (S)</b>	CCL_HE12.18	CMA_HE12.22
<b>Medium (M)</b>	CCL_HE12.22	-
<b>Long (L)</b>	CCL_HE12.30	CMA_HE12.26

► Ball joint screwdrivers.  
In manual or contra-angle version, allowing to screw the angled esthetic-bases only. The screwdriver and the compatible screw are yellow.



Version	Manual key	For contra-angle
<b>Medium (M)</b>	CCR_HE14.M	-
<b>Long (L)</b>	CCR_HE14.L	CMR_HE14.L

# REFERENCES AND COMPATIBILITIES



Brand	Compatible implant system	Profile Designer				Temporary abutment	Try-in kit	
		Shape	● h 1 mm	● h 2 mm	● h 3 mm			● h 4 mm
AB Dental®	Implant I2, I22, I5, I55, I10: standard platform Ø 3.75	A	ZSC35_I.A1	-	ZSC35_I.A3	-	ZSC_IPPC	KIE_U
		B	ZSC35_I.B1	-	ZSC35_I.B3	-		
		C	ZSC35_I.C1	-	ZSC35_I.C3	-		
Alpha-Bio Tec®	NeO, SPI, ICE, DFI, ATID: internal connection hexagonal (IH)	A	ZSC35_I.A1	-	ZSC35_I.A3	-	ZSC_IPPC	KIE_U
		B	ZSC35_I.B1	-	ZSC35_I.B3	-		
		C	ZSC35_I.C1	-	ZSC35_I.C3	-		
Anthogyr®	Axiom® REG and PX	A	AAX_I.A1	-	AAX_I.A3	-	AAX_IPPC	KIE_U
		B	AAX_I.B1	-	AAX_I.B3	-		
		C	AAX_I.C1	-	AAX_I.C3	-		
Astra Tech®	OsseoSpeed™ TX Ø 3.5 and Ø 4: Ocean or Aqua connection	A	NCI_I.A1	NCI_I.A2	-	NCI_I.A4	NCI_IPPC	KIE_3N
		A-10°		NCI_I.A2.10				
		A-20°		NCI_I.A2.20				
		B	NCI_I.B1	NCI_I.B2	-	NCI_I.B4		
		B		NCI_I.B2S	NCI_I.B3S			
		C	NCI_I.C1	NCI_I.C2	-	NCI_I.C4		
		C		NCI_I.C2S	NCI_I.C3S			
D	NCI_I.D1	NCI_I.D2	-	NCI_I.D4				
BioHorizons®	Internal, Tapered Internal, Tapered Plus: platform Ø 3.5 yellow	A	ZSC35_I.A1	-	ZSC35_I.A3	-	ZSC_IPPC	KIE_U
		B	ZSC35_I.B1	-	ZSC35_I.B3	-		
		C	ZSC35_I.C1	-	ZSC35_I.C3	-		
	Internal, Tapered Internal, Tapered Plus: platform Ø 4.5 green	B	ZSC45_I.B1	-	ZSC45_I.B3	-	ZSC_IPPC	KIE_U
C		ZSC45_I.C1	-	ZSC45_I.C3	-			
Biotech Dental®	Kontakt®, Kontakt S® Ø 3.6 - Ø 4.2 - Ø 4.8 et Ø 5.4	A	BKO_I.A1	-	BKO_I.A3	-	BKO_IPPC	KIE_U
		B	BKO_I.B1	-	BKO_I.B3	-		
		C	BKO_I.C1	-	BKO_I.C3	-		
Easy Implant®	Master-C, Master-S : connexion Ocean	A	NCI_I.A1	NCI_I.A2	-	NCI_I.A4	NCI_IPPC	KIE_3N
		A-10°		NCI_I.A2.10				
		A-20°		NCI_I.A2.20				
		B	NCI_I.B1	NCI_I.B2	-	NCI_I.B4		
		B		NCI_I.B2S	NCI_I.B3S			
		C	NCI_I.C1	NCI_I.C2	-	NCI_I.C4		
		C		NCI_I.C2S	NCI_I.C3S			
D	NCI_I.D1	NCI_I.D2	-	NCI_I.D4				



Brand	Compatible implant system	Profile Designer					Temporary abutment	Try-in kit
		Shape	● h 1 mm	● h 2 mm	● h 3 mm	● h 4 mm		
etk®	Naturall+ Ø 3, Naturactis Ø 3	A	-	NCI3_I.A2	-	NCI3_I.A4	NCI3_IPPC	-
	Naturall+, Natea+, Naturactis	A	NCI_I.A1	NCI_I.A2	-	NCI_I.A4	NCI_IPPC	KIE_3N
		A-10°	-	NCI_I.A2.10	-	-		
		A-20°	-	NCI_I.A2.20	-	-		
		B	NCI_I.B1	NCI_I.B2	-	NCI_I.B4		
		B	-	NCI_I.B2S	NCI_I.B3S	-		
		C	NCI_I.C1	NCI_I.C2	-	NCI_I.C4		
		C	-	NCI_I.C2S	NCI_I.C3S	-		
	D	NCI_I.D1	NCI_I.D2	-	NCI_I.D4			
Aesthética+2: RP (Ø 4.8), ibone G	D	ACI_IR (hauteur unique)				-	-	
Aesthética+2: WP (Ø 6.5), ibone G	C	ACI_IW (hauteur unique)				-	-	
Global D®	In-Kone® Universal et Primo	A	GIK_I.A1	-	GIK_I.A3	-	GIK_IPPC	KIE_U
		B	GIK_I.B1	-	GIK_I.B3	-		
		C	GIK_I.C1	-	GIK_I.C3	-		
Implant Direct™	Legacy® : plateforme Ø 3.5 verte	A	ZSC35_I.A1	-	ZSC35_I.A3	-	ZSC_IPPC	KIE_U
		B	ZSC35_I.B1	-	ZSC35_I.B3	-		
		C	ZSC35_I.C1	-	ZSC35_I.C3	-		
	Legacy® : plateforme Ø 4.5 violette	B	ZSC45_I.B1	-	ZSC45_I.B3	-	ZSC_IPPC	KIE_U
		C	ZSC45_I.C1	-	ZSC45_I.C3	-		
	InterActive™ Ø 3.2 et Ø 3.7 : plateforme Ø 3 violette	A	NCCN_I.A1	-	NCCN_I.A3	-	NCCN_IPPC	KIE_U
		B	NCCN_I.B1	-	NCCN_I.B3	-		
InterActive™ Ø 4.7 et Ø 5 : plateforme Ø 3.4 jaune	B	NCCR_I.B1	-	NCCR_I.B3	-	-	KIE_U	
	C	NCCR_I.C1	-	NCCR_I.C3	-			
MIS®	SEVEN et M4 Ø 3.75 - Ø 4.2 : hexagone interne plateforme standard SP violette	A	ZSC35_I.A1	-	ZSC35_I.A3	-	ZSC_IPPC	KIE_U
		B	ZSC35_I.B1	-	ZSC35_I.B3	-		
		C	ZSC35_I.C1	-	ZSC35_I.C3	-		
	SEVEN et M4 Ø 5 - Ø 6 : hexagone interne plateforme large WP verte	B	ZSC45_I.B1	-	ZSC45_I.B3	-	ZSC_IPPC	KIE_U
		C	ZSC45_I.C1	-	ZSC45_I.C3	-		
Nobel Biocare®	NobelActive®, NobelReplace® CC et NobelParallel™ CC : NP	A	NCCN_I.A1	-	NCCN_I.A3	-	NCCN_IPPC	KIE_U
		B	NCCN_I.B1	-	NCCN_I.B3	-		
	NobelActive®, NobelReplace® CC et NobelParallel™ CC : RP	B	NCCR_I.B1	-	NCCR_I.B3	-	-	KIE_U
		C	NCCR_I.C1	-	NCCR_I.C3	-		

## REFERENCES AND COMPATIBILITIES



Brand	Compatible implant system	Profile Designer					Temporary abutment	Try-in kit
		Shape	● h 1 mm	● h 2 mm	● h 3 mm	● h 4 mm		
Straumann®	Bone Level (BL) et Bone Level Tapered (BLT) Ø 3.3 : connexion CrossFit® NC	A	SBLN_I.A1	-	SBLN_I.A3	-	SBL_IPPC	KIE_U
		B	SBLN_I.B1	-	SBLN_I.B3	-		
	Bone Level (BL) et Bone Level Tapered (BLT) Ø 4.1 et Ø 4.8 : connexion CrossFit® RC	B	SBLR_I.B1	-	SBLR_I.B3	-	SBL_IPPC	KIE_U
		C	SBLR_I.C1	-	SBLR_I.C3	-		
	Soft Tissue Level® : Standard (S), Standard Plus (SP), Tapered Effect (TE) : connexion synOcta® RN	D	ACI_IR (hauteur unique)				-	-
Soft Tissue Level® : Standard (S), Standard Plus (SP), Tapered Effect (TE) : connexion synOcta® WN	C	ACI_IW (hauteur unique)				-	-	
Zimmer Biomet®	Tapered Screw-Vent®, Trabecular Metal™ : plateforme Ø 3.5 verte	A	ZSC35_I.A1	-	ZSC35_I.A3	-	ZSC_IPPC	KIE_U
		B	ZSC35_I.B1	-	ZSC35_I.B3	-		
		C	ZSC35_I.C1	-	ZSC35_I.C3	-		
	Tapered Screw-Vent®, Trabecular Metal™ : plateforme Ø 4.5 violette	B	ZSC45_I.B1	-	ZSC45_I.B3	-	ZSC_IPPC	KIE_U
		C	ZSC45_I.C1	-	ZSC45_I.C3	-		

# ESTHETIBASES

## Esthetibase Interfaces

For CAD-CAM prosthesis (CAD-CAM) in zircono, PMMA, e.max



The pre-milled are delivered individually with their fixing screws. The screw head is compatible with the external hexagonal keys of 1.2 mm.

Profile Designer iPhysio		height
height	shape	
h 1 mm	A, B, C et D	h 1 mm
h 2 mm	A, B, C et D	h 2 mm
h 3 mm	A, B et C	h 2 mm
h 4 mm	B et C	h 3 mm
	A et D *	h 4 mm

\* except for etk Naturall+ Ø 3 and Naturactis Ø 3 implants. iPhysio® Profile Designer of height 4 mm correspond to the EstTetibase height 3 mm

Brand	Compatible implant system	h 1 mm	h 2 mm	h 3 mm	h 4 mm	Screw
AB Dental®	Implant I2, I22, I5, I55, I10 : Ø 3.75 standard platform	ZIM_SC.35.PTO	ZIM_SC.35.PTO2	-	-	TEK_VP.18.65
Alpha-Bio Tec®	NeO, SPI, I.C.E., DFI, ATID : internal hexagon connection (IH)	ZIM_SC.35.PTO	ZIM_SC.35.PTO2	-	-	TEK_VP.18.65
Anthogyr®	Axiom® REG and PX	ANT_AX.PTO1	ANT_AX.PTO2	-	-	NVP_E35
Astra Tech®	OsseoSpeed™ TX Ø 3.5 and Ø 4 : Ocean or Aqua connection	NPC_PTO40.06	NPC_PTO40.16	NPC_PTO40.26	NPC_PTO40.36	NVP_E35
BioHorizons®	Internal, Tapered Internal, Tapered Plus : Ø 3.5 yellow platform	ZIM_SC.35.PTO	ZIM_SC.35.PTO2	-	-	TEK_VP.18.65
	Internal, Tapered Internal, Tapered Plus : Ø 4.5 green platform	ZIM_SC.45.PTO	ZIM_SC.45.PTO2	-	-	TEK_VP.18.65
Biotech Dental®	Kontakt®, Kontakt S® Ø 3.6 - Ø 4.2 - Ø 4.8 and Ø 5.4	BTH_KO.X.PTO	BTH_KO.X.PTO2	-	-	NVP_31
Easy Implant®	Master-C, Master-S : Ocean connection	NPC_PTO40.06	NPC_PTO40.16	NPC_PTO40.26	NPC_PTO40.36	NVP_E35
etk®	Naturall+ Ø 3, Naturactis Ø 3	-	NPC_PTO30.16	NPC_PTO30.26	-	NVP_31
	Naturall+, Natea+, Naturactis	NPC_PTO40.06	NPC_PTO40.16	NPC_PTO40.26	NPC_PTO40.36	NVP_E35
	Aesthética+2 : RP (Ø 4.8), ibone G	-	NPC_PTOA40.16.10	-	-	NVP_PTOA35
	Aesthética+2 : WP (Ø 6.5), ibone G	-	NPC_PTOA40.16.20	-	-	NVP_PTOA35
	In-Kone® Universal and Primo	APCC_PTO.48	-	-	-	APS_VF20.93
Legacy® : Ø 3.5 green platform	APCC_PTO.65	-	-	-	APS_VF20.93	
Global D®	Legacy® : Ø 4.5 purple platform	TEK_PTO.INK	TEK_PTO.INK2	-	-	TEK_VP.18.65
Implant Direct™	InterActive® Ø 3.2 and Ø 3.7 : Ø 3 purple platform	ZIM_SC.35.PTO	ZIM_SC.35.PTO2	-	-	TEK_VP.18.65
	InterActive® Ø 4.7 and Ø 5 : Ø 3.4 yellow platform	ZIM_SC.45.PTO	ZIM_SC.45.PTO2	-	-	TEK_VP.18.65
	SEVEN and M4 Ø 3.75 - Ø 4.2 : hexagonal connection inside purple	NOB_AC.N.PTO	NOB_AC.N.PTO2	-	-	NVP_E35
	SEVEN and M4 Ø 5 - Ø 6 : hexagonal connection inside green	NOB_AC.R.PTO	NOB_AC.R.PTO2	-	-	NVP_20.85
MIS®	NobelActive®, NobelReplace® CC and NobelParallel® CC : internal conical connection CC NP	ZIM_SC.35.PTO	ZIM_SC.35.PTO2	-	-	TEK_VP.18.65
	NobelActive®, NobelReplace® CC and NobelParallel® CC : internal conical connection CC RP	ZIM_SC.45.PTO	ZIM_SC.45.PTO2	-	-	TEK_VP.18.65
	NobelActive®, NobelReplace® CC et NobelParallel® CC : connexion conique interne CC NP	NOB_AC.N.PTO	NOB_AC.N.PTO2	-	-	NVP_E35
Nobel Biocare®	NobelActive®, NobelReplace® CC et NobelParallel® CC : connexion conique interne CC RP	NOB_AC.R.PTO	NOB_AC.R.PTO2	-	-	NVP_20.85

Brand	Compatible implant system	h 1 mm	h 2 mm	h 3 mm	h 4 mm	Screw
Straumann®	Bone Level (BL) et Bone Level Tapered (BLT) Ø 3.3 : connexion CrossFit® NC	STR_BL.N.PTO	STR_BL.N.PTO2	-	-	CPV_VC16.100
	Bone Level (BL) et Bone Level Tapered (BLT) Ø 4.1 et Ø 4.8 : connexion CrossFit® RC	STR_BL.R.PTO	STR_BL.R.PTO2	-	-	CPV_VC16.100
	Soft Tissue Level® : Standard (S), Standard Plus (SP), Tapered Effect (TE) : connexion synOcta® RN	APCC_PTO.48	-	-	-	APS_VF20.93
	Soft Tissue Level® : Standard (S), Standard Plus (SP), Tapered Effect (TE) : connexion synOcta® WN	APCC_PTO.65	-	-	-	APS_VF20.93
Zimmer Biomet®	Tapered Screw-Vent®, Trabecular Metal® : plateforme Ø 3.5 verte	ZIM_SC.35.PTO	ZIM_SC.35.PTO2	-	-	TEK_VP.18.65
	Tapered Screw-Vent®, Trabecular Metal® : plateforme Ø 4.5 violette	ZIM_SC.45.PTO	ZIM_SC.45.PTO2	-	-	TEK_VP.18.65

## ► Rotational Esthetibase interfaces

For CAD-CAM prosthesis (CAD-CAM) in zircono, PMMA, e.max

Brand	Compatible implant system	h 1 mm	h 2 mm	h 3 mm	h 4 mm	Screw
AB Dental®	Implant I2, I22, I5, I55, I10 : Ø 3.75 standard platform	ZIM_SC.35.PTC	-	-	-	TEK_VP.18.65
Alpha-Bio Tec®	NeO, SPI, I.C.E., DFI, ATID : internal hexagon connection (IH)	ZIM_SC.35.PTC	-	-	-	TEK_VP.18.65
Astra Tech®	OsseoSpeed™ TX Ø 3.5 and Ø 4 : Ocean or Aqua connection	NPC_PTO40.06	NPC_PTC40.16	NPC_PTC40.26	NPC_PTC40.36	NVP_E35
BioHorizons®	Internal, Tapered Internal, Tapered Plus : Ø 3.5 yellow platform	ZIM_SC.35.PTC	-	-	-	TEK_VP.18.65
	Internal, Tapered Internal, Tapered Plus : Ø 4.5 green platform	ZIM_SC.45.PTC	-	-	-	TEK_VP.18.65
Easy Implant®	Master-C, Master-S : connexion Ocean	NPC_PTC40.06	NPC_PTC40.16	NPC_PTC40.26	NPC_PTC40.36	NVP_E35
etk®	Naturall+, Natea+, Naturactis	NPC_PTC40.06	NPC_PTC40.16	NPC_PTC40.26	NPC_PTC40.36	NVP_E35
	Aesthetica+2 : RP (Ø 4.8), ibone G	APCC_PTC.48	-	-	-	APS_VF20.93
	Aesthetica+2 : WP (Ø 6.5), ibone G	APCC_PTC.65	-	-	-	APS_VF20.93
Implant Direct™	Legacy® : Ø 3.5 green platform	ZIM_SC.35.PTC	-	-	-	TEK_VP.18.65
	Legacy® : Ø 4.5 purple platform	ZIM_SC.45.PTC	-	-	-	TEK_VP.18.65
	InterActive® Ø 3.2 and Ø 3.7 : Ø 3 purple platform	NOB_AC.N.PTC	-	-	-	NVP_E35
	InterActive® Ø 4.7 and Ø 5 : Ø 3.4 yellow platform	NOB_AC.R.PTC	-	-	-	NVP_20.85
MIS®	SEVEN and M4 Ø 3.75 - Ø 4.2 : hexagonal connection inside purple	ZIM_SC.35.PTC	-	-	-	TEK_VP.18.65
	SEVEN and M4 Ø 5 - Ø 6 : hexagonal connection inside green	ZIM_SC.45.PTC	-	-	-	TEK_VP.18.65
Nobel Biocare®	NobelActive®, NobelReplace® CC and NobelParallel® CC : internal conical connection CC NP	NOB_AC.N.PTC	-	-	-	NVP_E35
	NobelActive®, NobelReplace® CC and NobelParallel® CC : internal conical connection CC RP	NOB_AC.R.PTC	-	-	-	NVP_20.85
Straumann®	Bone Level (BL) and Bone Level Tapered (BLT) Ø 3.3 : NC CrossFit® connection	STR_BL.N.PTC	-	-	-	CPV_VC16.100
	Bone Level (BL) and Bone Level Tapered (BLT) Ø 4.1 and Ø 4.8 : RC CrossFit® connection	STR_BL.R.PTC	-	-	-	CPV_VC16.100
	Soft Tissue Level® : Standard (S), Standard Plus (SP), Tapered Effect (TE) : connexion synOcta® RN	APCC_PTC.48	-	-	-	APS_VF20.93
	Soft Tissue Level® : Standard (S), Standard Plus (SP), Tapered Effect (TE) : connexion synOcta® WN	APCC_PTC.65	-	-	-	APS_VF20.93
Zimmer Biomet®	Tapered Screw-Vent®, Trabecular Metal® : Ø 3.5 green platform	ZIM_SC.35.PTC	-	-	-	TEK_VP.18.65
	Tapered Screw-Vent®, Trabecular Metal® : Ø 4.5 purple platform	ZIM_SC.45.PTC	-	-	-	TEK_VP.18.65



## PRE-MILLED

### ► Pre-milled or abutments with apre-fabricated connection

To manufacture your customized abutments



The pre-milled are delivered individually with their fixing screws. The screw head is compatible with the external hexagonal keys of 1.2 mm.

etk pre-milled abutments have an 8 mm hexagon basis that shall be fixed into a universal cylindrical mounting holder inside the milling machine. They can also be fixed directly into an hexagonal clamp. The etk universal mounting holder can hold 4 pre-milled abutments. It is suitable for any type of 3/5 axis milling machine.

It shall be installed in place of the standard 98.5 mm disc. The mounting holder can be integrated through any open CAM software (like Worknc). etk pre-milled abutments can also be used in the mounting cassette provided by the company S3Del (Mâcon - France), that can be integrated in any open CAM software.



Ref

MONT\_U.PP

Brand	Compatible implant and prosthetic system	Reference	Screw
AB Dental®	Implant I2, I22, I5, I55, I10 : Ø 3.75 standard platform	ZIM_SC.35.PP	TEK_VP.18.65
Alpha-Bio Tec®	NeO, SPI, I.C.E., DFI, ATID : internal hexagon connection (IH)	ZIM_SC.35.PP	TEK_VP.18.65
Anthogyr®	Axiom® REG and PX	ANT_PP.AX	ANT_VP.16.65
Astra Tech®	OsseoSpeed™ TX Ø 3.5 and Ø 4 : Ocean or Aqua connection	NPS_PER.35	NVP_35
BioHorizons®	Internal, Tapered Internal, Tapered Plus : Ø 3.5 yellow platform	ZIM_SC.35.PP	TEK_VP.18.65
	Internal, Tapered Internal, Tapered Plus : Ø 4.5 green platform	ZIM_SC.45.PP	TEK_VP.18.65
Biotech Dental®	Kontakt®, Kontakt S® Ø 3.6 - Ø 4.2 - Ø 4.8 and Ø 5.4	BTH_KO.X.PP	NVP_31
Easy Implant®	Master-C, Master-S : Ocean connection	NPS_PER.35	NVP_35
etk®	Naturall+ Ø 3, Naturactis Ø 3	NPS_PER.31	NVP_31
	Naturall+, Natea+, Naturactis	NPS_PER.35	NVP_35
	Aesthética+2; ibone G RP 4.8	APS_PER.48	APS_VF20.93
	Aesthética+2; ibone G WP : 6.5	APS_PER.65	APS_VF20.93
Global D®	In-Kone® Universal et Primo	TEK_PP.IN	TEK_VP.18.65
Implant Direct™	Legacy® : Ø 3.5 green platform	ZIM_SC.35.PP	TEK_VP.18.65
	Legacy® : Ø 4.5 purple platform	ZIM_SC.45.PP	TEK_VP.18.65
	InterActive® Ø 3.2 and Ø 3.7 : Ø 3 purple platform	NOB_AC.N.PP	NVP_35
	InterActive® Ø 4.7 and Ø 5 : Ø 3.4 yellow platform	NOB_AC.R.PP	NVP_20.85
MIS®	SEVEN and M4 Ø 3.75 - Ø 4.2 : hexagonal connection inside purple	ZIM_SC.35.PP	TEK_VP.18.65
	SEVEN and M4 Ø 5 - Ø 6 : hexagonal connection inside green	ZIM_SC.45.PP	TEK_VP.18.65
Nobel Biocare®	NobelActive®, NobelReplace® CC et NobelParallel® CC : connexion conique interne CC NP	NOB_AC.N.PP	NVP_35
	NobelActive®, NobelReplace® CC et NobelParallel® CC : connexion conique interne CC RP	NOB_AC.R.PP	NVP_20.85
Straumann®	Bone Level (BL) et Bone Level Tapered (BLT) Ø 3.3 : connexion CrossFit® NC	STR_BL.N.PP	CPV_VC16.100
	Bone Level (BL) et Bone Level Tapered (BLT) Ø 4.1 et Ø 4.8 : connexion CrossFit® RC	STR_BL.R.PP	CPV_VC16.100
	Soft Tissue Level® : Standard (S), Standard Plus (SP), Tapered Effect (TE) : connexion synOcta® RN	APS_PER.48	APS_VF20.93
	Soft Tissue Level® : Standard (S), Standard Plus (SP), Tapered Effect (TE) : connexion synOcta® WN	APS_PER.65	APS_VF20.93
Zimmer Biomet®	Tapered Screw-Vent®, Trabecular Metal® : Ø 3.5 green platform	ZIM_SC.35.PP	TEK_VP.18.65
	Tapered Screw-Vent®, Trabecular Metal® : Ø 4.5 purple platform	ZIM_SC.45.PP	TEK_VP.18.65



[www.iphysio.dental](http://www.iphysio.dental) | [info@lyra.dental](mailto:info@lyra.dental) | Tel. +33(0) 1 76 42 00 60

Manufactured by euroteknika - 726 rue du Général de Gaulle, 74700 Sallanches (France). The iPhysio® Profile Designer manufactured by euroteknika and distributed by LYRA France is a Class IIb (European Directive 93/42/CEE) medical device which conforms to current standards and bearers of the CE0459 marking. Non-funded by Social Security, it must be used by oral health professionals. Carefully read the instruction leaflet and the user manual. All document edited by LYRA refers to our terms sales in force. Photos are non-contractual - Any reproduction, even of a part of it, is strictly prohibited.



Ref\_iphysio\_GB\_i09\_2022\_03